

442

## Ball valve of stainless steel with threaded end/ weld end DN 15 - 50

03.06.2008

### Operation

Ball valve 442 is a tightly closing on-off valve suitable for liquid and gas pipe systems. It is used for example in industrial pipe lines.

**Nominal pressure** PN 40 DN 15 - 50  
**Tightness class** ISO 5208, EN 12266-1 RATE A  
**Operating temperature** max +220°C/ min -40°C

The max pressure difference depends on the working temperature

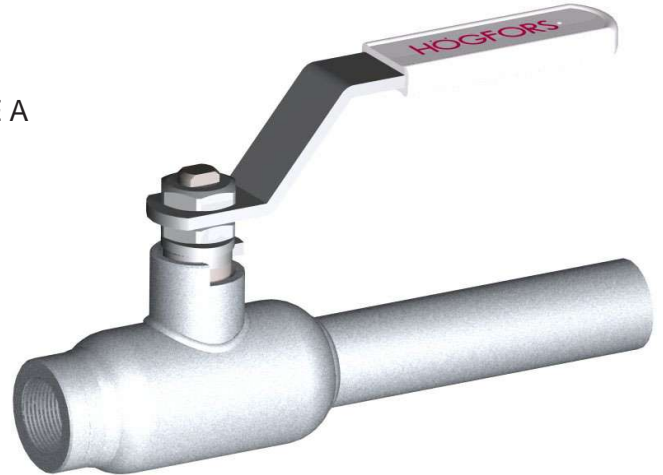
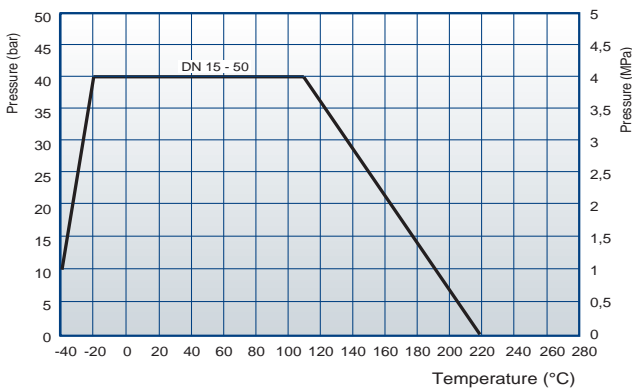

### Construction

This welded ball valve with threaded end/ weld end and the body is made of stainless steel. Floating ball and blow-out proof stem are made of stainless steel. Ball sealing is of PTFE+C. Stem has tightable PTFE-rings.

Conform with the requirements of the Council Directive 97/23/EC on Pressure Equipment, marking:

Class: Gas, group 1



**Nominal dimensions:** DN15 - 50

**Product codes:** 442TS\_ \_ \_ with handlever

### Materials

**Body:** EN 10217-7 1.4404, DIN 17457 1.4404  
**Ball:** EN 10217-7 1.4404, DIN 17457 1.4404  
**Seal:** PTFE+C  
**Stem seal:** PTFE

442

# Ball valve of stainless steel with threaded end/ weld end DN 15 - 50

03.06.2008

## Dimensions

DN	PN	KV <sub>100</sub>	d	R	D	s	L	L1	H	h	l	Weight kg
15	40	8	10	G 1/2	21,3	1,6	157	42	73	30	110	0,4
20	40	13	15	G 3/4	26,9	1,6	165	50	73	30	110	0,6
25	40	25	20	G 1	33,7	2,0	170	55	95	36	140	0,8
32	40	41	24	G 1 1/4	42,4	2,0	195	65	98	36	140	1,2
40	40	65	31	G 1 1/2	48,3	2,0	200	70	122	47	180	2,0
50	40	100	39	G 2	60,3	2,0	235	85	128	47	180	2,7

